

Curb Extensions

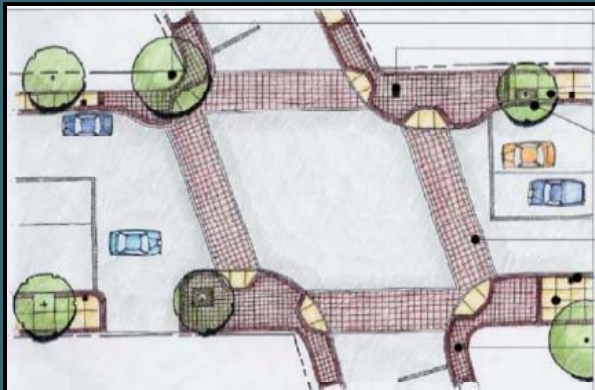

DEFINITION: Also known as curb “bump-outs,” curb extensions are a widening of sidewalk and an angled narrowing of roadway. Often curb extensions will be accompanied by textured cement that dips down to the level of the street signaling the beginning of a crosswalk or bollards separating the curb from the street edge. Street furniture such as planters, benches, trees, etc. also commonly accompany curb extensions.



BENEFITS:

- Reduces crosswalk lengths which improves pedestrian safety
- Helps to frame on-street parking
- Elevates pedestrians
- Assists in slowing traffic

CONSIDERATIONS:

- Can create snow removal and drainage concerns